

User's Manual

COFFEE MAKER

FP-78SCM015LDTL-B1 / FP-78SCM030LDTL-R1

Please read this User's Manual carefully for proper use of Midea Coffee Maker.



- This appliance is intended to be used in household and similar applications such as:
 - Staff kitchen areas in shops, office and other working environments;
 - farm houses;
 - by clients in hotels, motels and other residential type environments;
 - bed and breakfast type environments.
- If the supply cord is damaged, it must be replaced by the manufacturer, its service agent or similarly qualified persons in order to avoid a hazard.
- The appliance must not be immersed.
- The coffee-maker shall not be placed in a cabinet when in use.
- Cleaning and user maintenance shall not be made by children without supervision.
- The surfaces are liable to get hot during use.
- Do not use the appliance if the surface is cracked.
- The filling aperture must not be opened during use.
- The instructions for all appliances shall include:
 - details on how to clean the surfaces in contact with food;
 - a warning of potential injury from misuse;
 - a statement that the heating element surface is subject to residual heat after use.
- If this product is often used where the water has high mineral content, boil with proper amount of lemonade at least once a month to remove scale.
- Do not exceed the maximum water mark or below the minimum water mark when adding water, otherwise the appliance may not work normally or even cause danger.
- Do not use appliance when it is out of water, use only fresh cold water to make coffee.
- Do not heat the cup in the oven (including microwave oven) or on an open flame.

- The porcelain cup is easy to crack, please handle with care. If the cups have signs of cracking, please stop using appliances, and contact the manufacturer's designated local service provider to purchase replacement.
- The temperature of the cold water poured into the machine should not be too low. The recommended water temperature is 10 ° C-35 ° C.
- As the appliances are coated with protective grease on some internal parts, it may emit some smoke or smell when use for the first time, it will disappear after few times.
- Please use the coffee spoon supplied with the machine, the amount of coffee powder added is no more than one spoon.
- In case of supply cord damage, the cord should be replaced by professionals of the Manufacturer, the Maintenance Department or similar departments.
- This appliance is not intended for use by persons (including children) with reduced physical, sensory or mental capabilities, or lack of experience and knowledge, unless they have been given supervision or instruction concerning use of the appliance by a person responsible for their safety.
- Children should be supervised to ensure that they do not play with the appliance.
- Misuse the appliance can have potential risks, do not misuse.
- The heating element surface is subject to residual heat after use, do not touch.



The appliance must not be disposed of with regular household waste. At the end of its service life, the appliance must be properly delivered to a collection point for the recycling of electrical and electronic equipment. By Collection and recycling of old appliances, you are making an important contribution to the conservation of our natural resources and provide for environmentally sound and healthy disposal.

Specification and part names

The product is subject to the real object.

● Part name

FP-78SCM015LDTL-B1

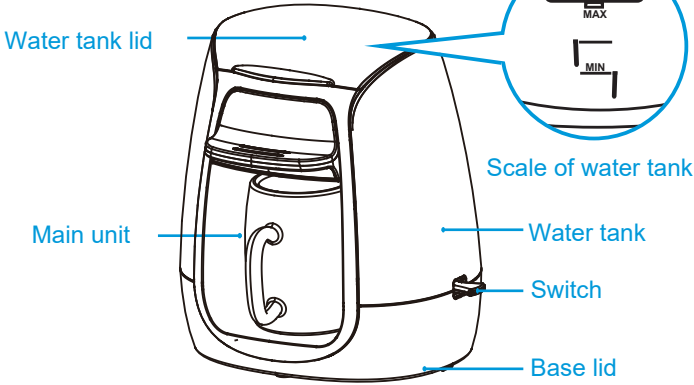

Porcelain cup



Measuring spoon



Filter



Funnel

FP-78SCM030LDTL-R1

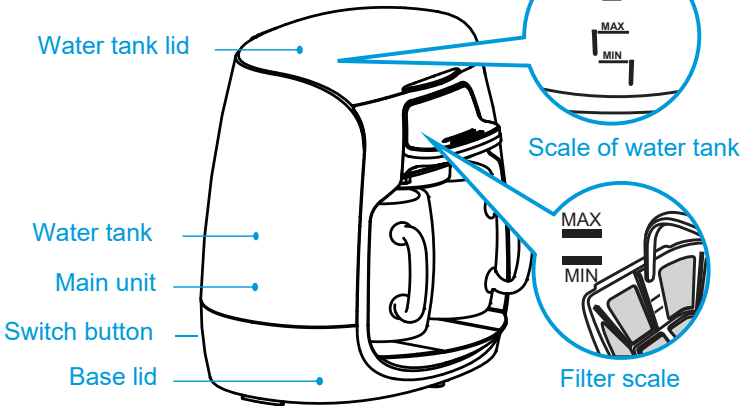

Porcelain cup



Measuring spoon



Filter



Funnel



1. The picture above is for reference only, as appearance varies among products. The product is subject to the real object.
2. This product is subject to any technical improvement which will be incorporated into the new version of this manual in the future without the prior notice.

Instructions for use



Before using the coffee-maker, please read through the instructions thoroughly. Follow the operating instructions

Tips carefully and pay special attention to safety instructions, and the coffee-maker will perform optimally and with durability.

● Attention should be paid when the coffee-maker is used first time.

1. When using coffee-maker for the first time, boil clear water once without the coffee powder.
2. When inserting the funnel, be sure to hear a clicking sound before it starts to work.
3. Insert the plug into the socket.
4. Open the water tank lid, pour in cold water, then close the water tank lid.
5. Place the porcelain cup in the correct position.
6. Turn on the switch and start working.

● Brew coffee



- 1 Open the tank lid and add in appropriate amount of water, and do not move the machine again after the water is added.



- 2 Ensure that water does not exceed the maximum water level of the tank.

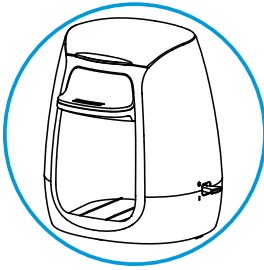

3 Close the water tank lid.

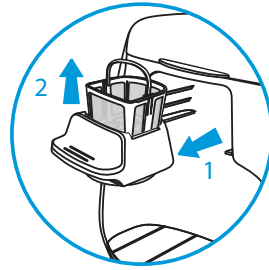

4 Take out the funnel and put the desired amount of coffee powder in the filter.
(Please use the coffee spoon supplied with the machine, the amount of coffee powder added is no more than one spoon)

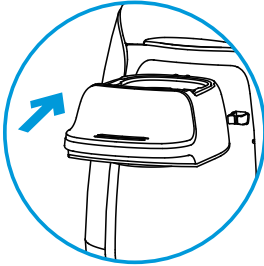

5 Insert the funnel, you need to hear the clicking sound to ensure that the assembly is in place.



6 Make sure the porcelain cup is placed in the correct position.

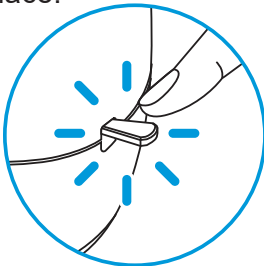

7 Press the switch and take note whether the switch light is on.

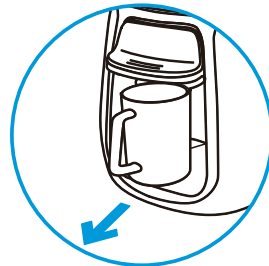

8 After brewing coffee, the machine automatically switches off and the indicator light go off. Wait one minute before removing the coffee cup.

● Care and Cleaning

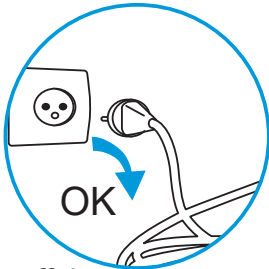

1 Turn off the power.

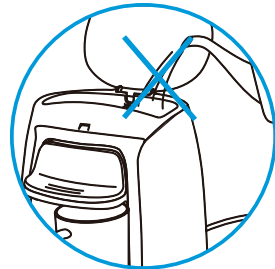

2 Do not pour water into the coffee-maker again. (make sure there is no residual water in the water tank.)

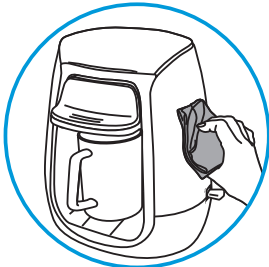

3 Use a dry cloth to wipe the coffee-maker.



4 The porcelain cup can be washed and brushed with a mixture of warm water and detergent. The porcelain cup cannot be washed in a dishwasher. Drain off the coffee powder in the filter in a timely manner, and rinse with clear water.

● Descaling

Develop the habit of descaling can enable your coffee-maker to put forth a flawless performance. Coffee powder is not needed in the process of descaling, add lemonade into the clean water, and refer to the coffee brewing procedure to carry this out. If you use the coffee-maker once or twice a day, you may refer to the following standard of descaling:

- Soft water, descale once every 6 months.
- Medium water, descale once every 2 - 3 months.
- Hard water, descale once every 6 - 8 weeks.

● Some suggestions on the environment protection

If your appliance has been damaged and cannot be used, disposal will cause environmental damage, you should hand over to the recycling company in according to the local laws and regulations. Wood filter paper can be treated as a compost.

Cautions

- This appliance is for household use only. Do not use outdoors.
- This appliance is not intended for use by persons (including children) with reduced physical, sensory or mental capabilities, or lack of experience and knowledge, unless they have been given supervision or instruction concerning use of the appliance by a person responsible for their safety.
- This appliance can be used by children aged from 8 years and above if they have been given supervision or instruction concerning use of the appliance in a safe way and if they understand the hazards involved. Cleaning and user maintenance shall not be made by children unless they are older than 8 and supervised. Keep the appliance and its cord out of reach of children aged less than 8 years.
- Children should be supervised to ensure that they do not play with the appliance.
- Children shall not play with the appliance.
- Appliances can be used by persons with reduced physical, sensory or mental capabilities or lack of experience and knowledge if they have been given supervision or instruction concerning use of the appliance in a safe way and understand the hazards involved.

● Specification

Model	Volume	Voltage Frequency	Rated Power
FP-78SCM030LDTL-R1	0.3L	220-240V~60Hz	450W
FP-78SCM015LDTL-B1	0.15L	220-240V~60Hz	300W



The design and specifications are subject to change without prior notice for product improvement. Consult with your dealer or manufacturer for details.

A quality product of



CONCEPCION MIDEA INC.



Midea Customer Care
Email: customercare@midea.com.ph
Toll free: 1-800-10-863-5522
Landline: (02) 863-55-22
Viber/SMS: (0917) 863-5522
Monday - Sunday / 8:00am - 8:00pm

For more information, please visit our website www.midea.com.ph